

# CLIFF

## CROCODILE CLIPS

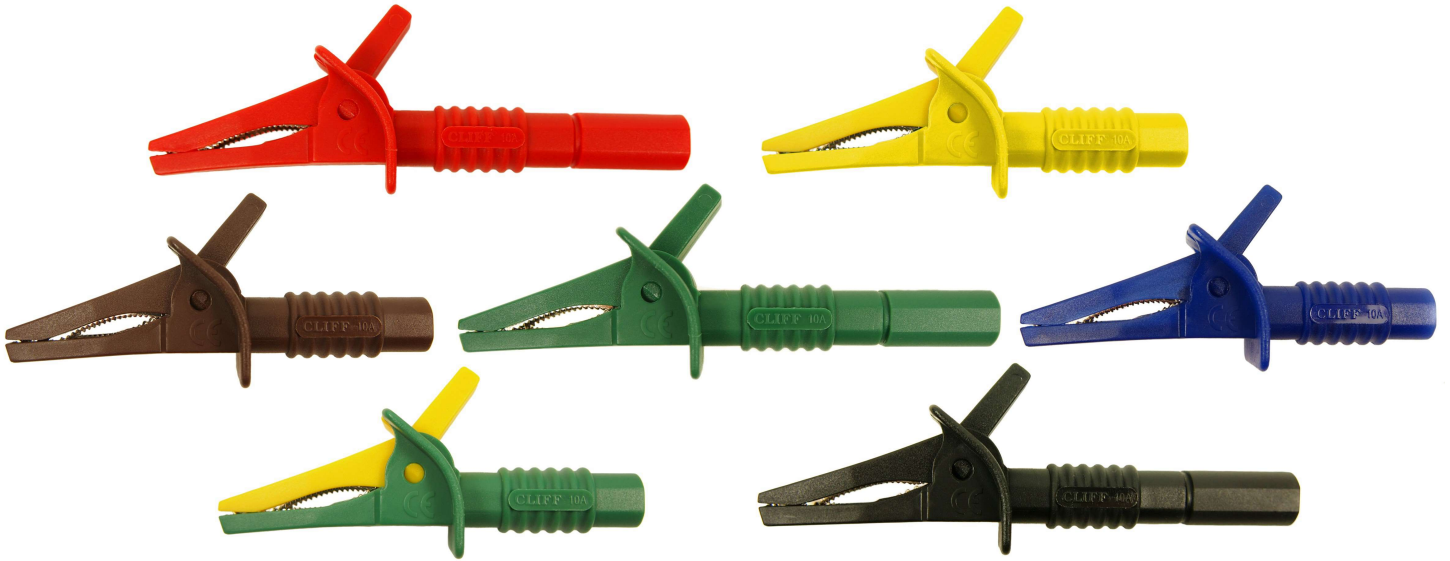

Basic Rating  
600V CAT III, (1000V CAT II). EN61010 compliant.

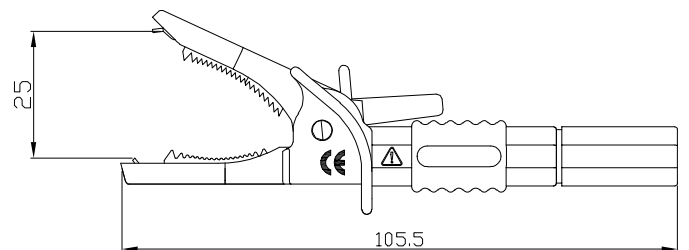
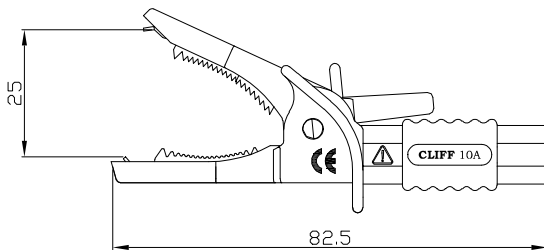
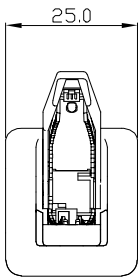

### Part No.

#### 600V Croc Clip

- FCR7924** - CROC CLIP CRC/01 YELLOW
- FCR7925** - CROC CLIP CRC/01 GREEN/YELLOW
- FCR7940** - CROC CLIP CRC/01 BLACK
- FCR7941** - CROC CLIP CRC/01 RED
- FCR7942** - CROC CLIP CRC/01 GREEN
- FCR7943** - CROC CLIP CRC/01 BLUE
- FCR7944** - CROC CLIP CRC/01 BROWN

### Part No.

#### 600V Extended Croc Clip

- FCR7940A** - CROC CLIP CRC/01X BLACK
- FCR7941A** - CROC CLIP CRC/01X RED
- FCR7942A** - CROC CLIP CRC/01X GREEN
- FCR7943A** - CROC CLIP CRC/01X BLUE
- FCR7944A** - CROC CLIP CRC/01X BROWN

# CLIFF

## CROCODILE CLIPS

### Key Features / Product Overview

- Compatible with standard 4mm shrouded plugs.
- Conforms to EN61010-031
- IEC Measurement Category II - CAT II equipment is designed for measurements performed on circuits directly connected to the low-voltage installation.
- IEC Measurement Category III - CAT III equipment is designed for measurements performed in the building installation.

### Technical Specifications

- Croc Clip – 1kV CAT II / 600V CAT III AC/DC 10A  (Double Insulated)
- Designed to comply with EN61010-031
- Environmental ratings: -10 °C to 40 °C (14 °F to 104 °F), altitude: 2000 m (6,562 ft)
- Not for permanent or semi-permanent connection.

### Warnings and Description of Markings

Double or Reinforced Insulation 

Caution 

UK Conformity Assessed

Conformité Européenne

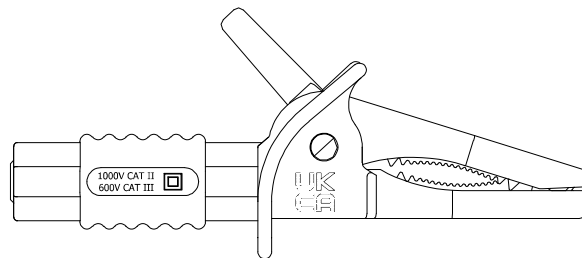

### To prevent electric shock or personal injury:

- The MEASUREMENT CATEGORY of a combination of a probe assembly, croc clip and accessories is the LOWER of the MEASUREMENT CATEGORIES of the probe assembly, croc clip and accessories.
- It is the end user's responsibility to ensure this device is used in a safe manner to ensure no injury is caused to operators. Failure to follow these instructions or use this equipment in a manner not specified by the manufacturer, could impair the safety of the equipment.
- Protect the leads and accessories from damage, e.g., cuts and abrasions. Keep clean and dry.
- Before use check the assembly for damage - If in doubt DO NOT USE.
- Equipment, test leads, croc clips and accessories should be inspected and tested regularly during their life to ensure the integrity of the insulation and that their continuity has not been compromised. If in doubt, contact the manufacturer for advice.
- DO NOT change accessories while connected to live or potentially live circuits
- Check the protection features, fusing and safety ratings of the test meter itself are compatible before using with these test leads.
- Clean with a soft towel moistened with water and mild detergent. (DO NOT IMMERSER in liquid).
- The croc clip does not contain any serviceable parts. If in doubt please contact the manufacturer, DO NOT attempt to service the croc clip or accessories.
- DO NOT USE in wet or damp locations.
- DO ENSURE that the test leads are firmly connected to the instrument and other accessories.
- DO NOT USE above the maximum ratings.
- DO NOT USE the croc clip if the insulation around the jaws or 4mm socket are damaged or worn.

# CLIFF

## CROCODILE CLIPS

### Key Features / Product Overview

- Compatible with Cliff Test Probes TPR1 & TPR1C incorporating a 4mm lantern probe tip connector.
- Conforms to EN61010-031
- IEC Measurement Category II - CAT II equipment is designed for measurements performed on circuits directly connected to the low-voltage installation.
- IEC Measurement Category III - CAT III equipment is designed for measurements performed in the building installation.

### Technical Specifications

- Croc Clip – 1kV CAT II / 600V CAT III AC/DC 10A  (Double Insulated)
- Designed to comply with EN61010-031
- Environmental ratings: -10 °C to 40 °C (14 °F to 104 °F), altitude: 2000 m (6,562 ft)
- Not for permanent or semi-permanent connection.

### Warnings and Description of Markings

Double or Reinforced Insulation 

Caution 

UK Conformity Assessed

Conformité Européenne

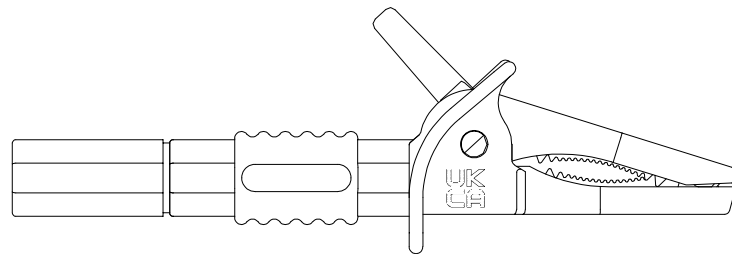

### To prevent electric shock or personal injury:

- The MEASUREMENT CATEGORY of a combination of a probe assembly, croc clip and accessories is the LOWER of the MEASUREMENT CATEGORIES of the probe assembly, croc clip and accessories.
- It is the end user's responsibility to ensure this device is used in a safe manner to ensure no injury is caused to operators. Failure to follow these instructions or use this equipment in a manner not specified by the manufacturer, could impair the safety of the equipment.
- Protect the leads and accessories from damage, e.g., cuts and abrasions. Keep clean and dry.
- Before use check the assembly for damage - If in doubt DO NOT USE.
- Equipment, test leads, croc clips and accessories should be inspected and tested regularly during their life to ensure the integrity of the insulation and that their continuity has not been compromised. If in doubt, contact the manufacturer for advice.
- DO NOT change accessories while connected to live or potentially live circuits
- Check the protection features, fusing and safety ratings of the test meter itself are compatible before using with these test leads.
- Clean with a soft towel moistened with water and mild detergent. (DO NOT IMMERSE in liquid).
- The croc clip does not contain any serviceable parts. If in doubt please contact the manufacturer, DO NOT attempt to service the croc clip or accessories.
- DO NOT USE in wet or damp locations.
- DO ENSURE that the test leads are firmly connected to the instrument and other accessories.
- DO NOT USE above the maximum ratings.
- DO NOT USE the croc clip if the insulation around the jaws or 4mm socket are damaged or worn.