

ISS.	AMEND	DATE
4	REDRAWN	18/02/94
5	▲ P/No CHANGED	01/03/94
6	KNURL CHANGED	31/05/94
7	GROOVE ADDED	29/03/95
8	GROOVE WAS 3.1	04/01/96
9	6.70 WAS 7.0	10/01/96
10	PLUG SCREW ADD	09/04/96
11	● P/No CHANGED	17/10/96
12	ADD CE VARS	02/12/96
13	UPDATE+LONG SPINDLE	17/06/15

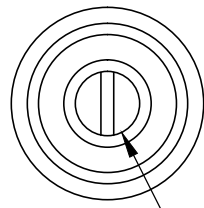

CE SCREW PLUG VARIANT
ENQUIRE WITH SALES
FOR MOQ + AVAILABILITY

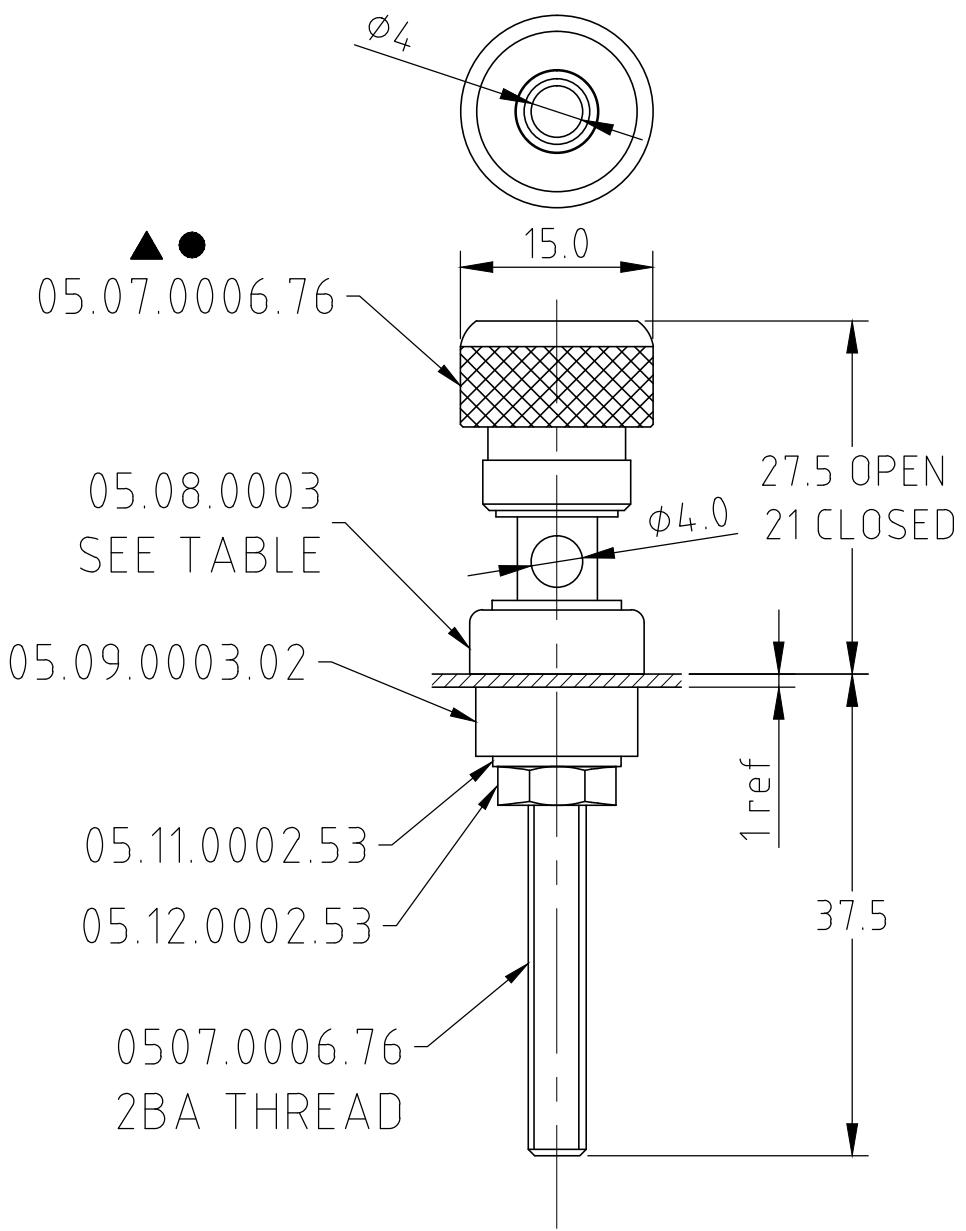

NOTE

- a) ALL PARTS SUPPLIED BULK PACKED UNASSEMBLED
- b) CE VARIANT HAS A THREAD IN THE TOP 4mm HOLE TO ACCEPT CL15981 SCREW PLUG.

PART No.	TOP INS
CL159707	RED
CL159708	BLACK

RoHS
COMPLIANT

TOLERANCE

NO DEC. PLACE	±
1 DEC. PLACE	±
2 DEC. PLACE	±
HOLE Ø	±
ANGLES	±
UNLESS OTHERWISE STATED	

Cliff Electronic Components Ltd.
76 Holmethorpe Avenue, Holmethorpe Industrial Estate,
Redhill, Surrey, RH1 2PF, England, UK
Tel: 01737-771375 Fax: 01737-766012 Website: www.cliffuk.co.uk

DIMENSIONS IN MILLIMETERS UNLESS OTHERWISE STATED. WORK TO DIMENSIONS. REMOVE ALL BURRS. IF IN DOUBT ASK.

3rd ANGLE PROJECTION:

DO NOT SCALE

MATERIAL: BRASS / PP SMOOTH FINISH ON KNOB FACES

TITLE: TERMINAL TP6ML / TP6MLCE / VARIANTS

FINISH: GOLD 0.02µ ON SHAFT / KNOB. OTHER PARTS NICKEL

DRAWN: C.A.M.J.

APPROVED: R.W.T.

DRWG. No. **CL159707**

FORM: A4DRWGH

THE CONTENTS OF THIS DOCUMENT MUST NOT BE COPIED OR DISCLOSED TO A 3rd PARTY WITHOUT WRITTEN PERMISSION OF CLIFF UK. © 1994