

CLIFF

BLANK FEEDTHROUGH CONNECTOR

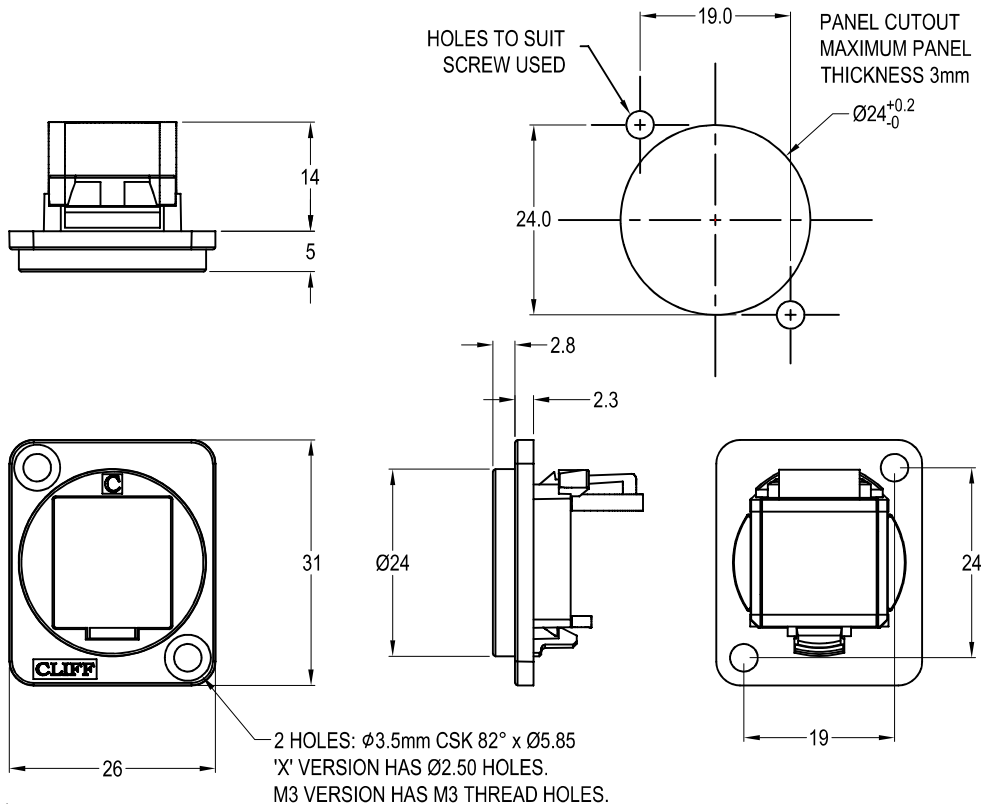

Feedthrough Features

- Fits standard XLR Ø24mm cutout.
- No soldering or punch termination. Use standard cable for each connector style.
- Front or rear mounted.
- Low rear profile

General:

Please note: Functionality is affected by cable quality, length and cable wiring configuration.

Material:

1. Insert: ABS
2. Plastic Frame: Polyamide UL94 V-2
3. Metal Frame: Diecast, Black or Nickel plated

Other models available:

Part No.

CP30241	Blanking Plate Black plastic frame, CSK holes
CP30241M	Blanking Plate Nickel plated metal frame, CSK holes
CP30241M3	Blanking Plate Nickel plated metal frame, M3 holes
CP30241MB	Blanking Plate Black metal frame, CSK holes
CP30241M3B	Blanking Plate Black metal frame, M3 holes
CP30241X	Blanking Plate Black plastic frame, PLAIN holes