

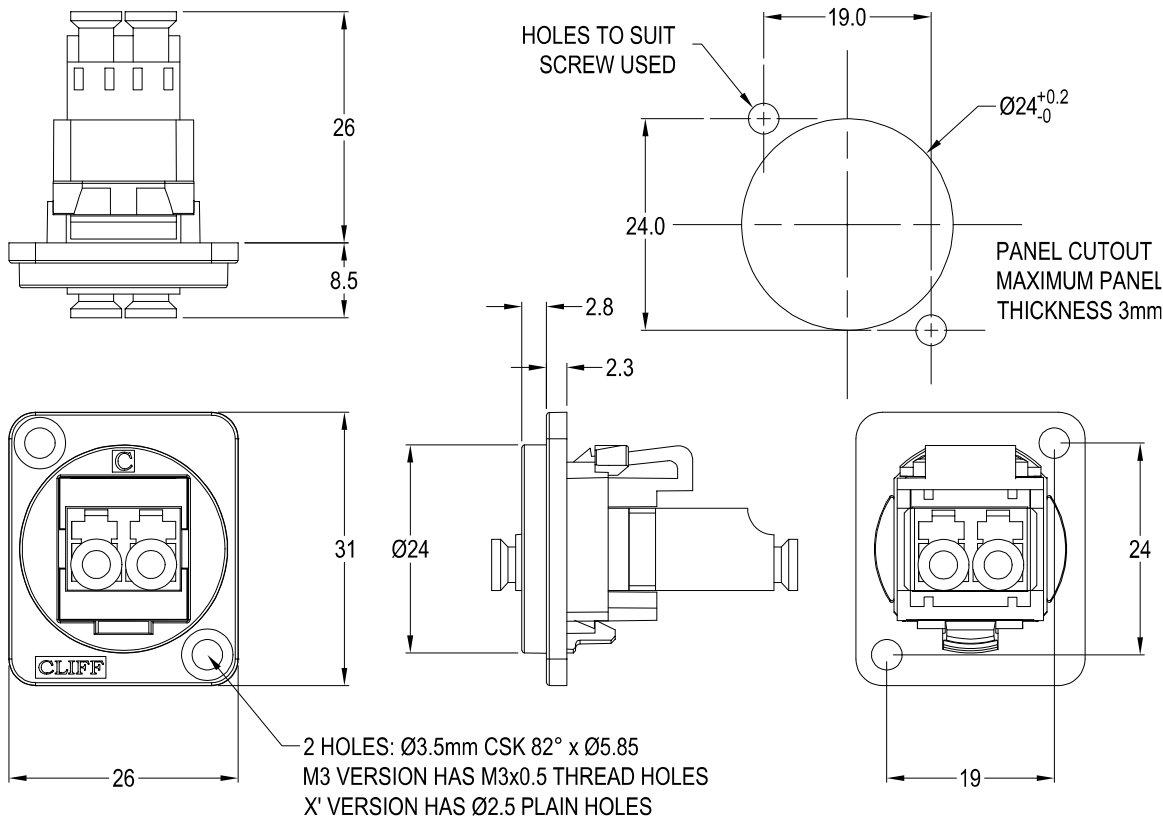

# LC DUPLEX MM FEEDTHROUGH CONNECTOR



### Feedthrough Features

- Fits standard XLR Ø24mm cutout.
- No soldering or punch termination. Use standard cable for each connector style.
- Front or rear mounted.
- Low rear profile

### General:

Please note: Functionality is affected by cable quality, length and cable wiring configuration.

### VARIANTS

#### Part No.

<b>CP30214</b>	LC Duplex MM Black plastic frame, CSK holes
<b>CP30214M</b>	LC Duplex MM Nickel plated metal frame, CSK holes
<b>CP30214M3</b>	LC Duplex MM Nickel plated metal frame, M3 holes
<b>CP30214MB</b>	LC Duplex MM Black metal frame, CSK holes
<b>CP30214M3B</b>	LC Duplex MM Black metal frame, M3 holes
<b>CP30214X</b>	LC Duplex MM Black plastic frame, PLAIN holes

### Material:

1. Coupler Body: PC UL94 V-2 - Beige
2. Plastic Frame: PA66 UL94 V-2 - Black
3. Metal Frame: Diecast, Black or Nickel plated
4. Sleeve: Ceramic
5. Dust Cover: PE - White
6. Insert: ABS UL94 V-2 - Black

### Notes:

1. Insertion Loss: ≤0.3dB
2. Dust caps may vary

